

GEKO

Electromechanical automation for swing gates
up to 2,5 m - 250 kg



NETLINK OPERATOR
This operator is compatible with the NETLINK System and can be programmed with DEAINSTALLER and NETBOX

Sliding arm (optional)



Can be used with external unlocking device by cable (art. GEKO/SF; to be used with BLINDOS - optional)



KIT CLIMB to allow you to install on a slope with a gradient up to 12% (optional)





Compatible with the Apps



KIT

24V = operators with control board and encoder, without arm



COD.	Art.				OTHER CHARACTERISTICS
628000	GEKO		✓	NET24N	<ul style="list-style-type: none"> • 1 operator • Mechanical stops • Speed adjustment and slow down in opening and closing
628010	GEKO/2		✓	NET24N	<ul style="list-style-type: none"> • 2 operators / 1 control board • Mechanical stops • Speed adjustment and slow down in opening and closing

All models have: arm not included. N.1 control board NET24N, mounting plate and limit switches included.

DIMENSIONS WITH ARMS

Articulated arm

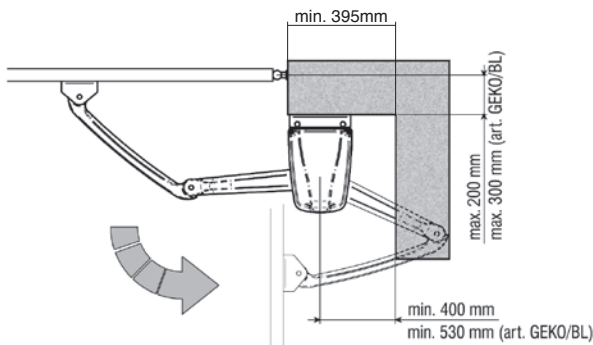

Sliding arm

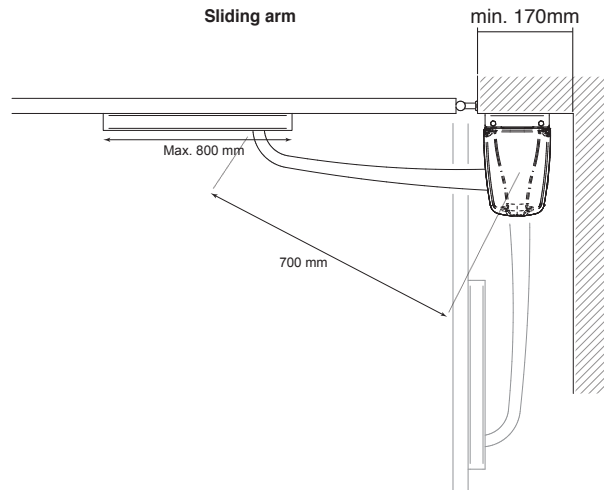

Refer to instructions manual for installation dimensions

GUIDE TO USE

TECHNICAL INFO	GEKO
Motor power supply (V)	24V =
Maximum power absorption (W)	80
Max torque (Nm)	180
Duty cycle (cycles/hours)	20
N. max cycles in 24h.	60
Operating temperature (°C)	-20 ÷ 50
90° Opening time (s)	16
Weight with packing (Kg)	12
Sound pressure (dBA)	< 70
Protection level	IP44

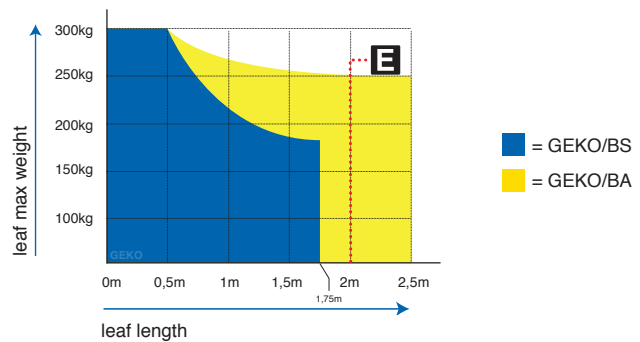

If the leaf length is bigger than 2m or if you use reversible models you must install the electric-lock to block the gate in closed position. The height and the leaf structure, as well as the presence of strong wind, can cause the reduction of the value of the data contained in table or make it necessary to use an electric lock also for leaves shorter than 2m.

EXAMPLE OF A TYPICAL INSTALLATION

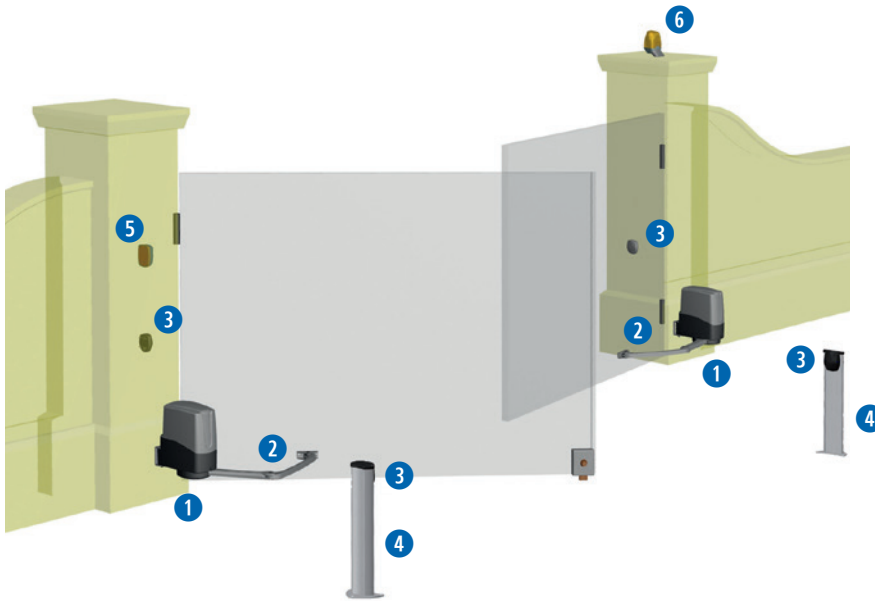

DIMENSIONS (with arm art. GEKO/BA)

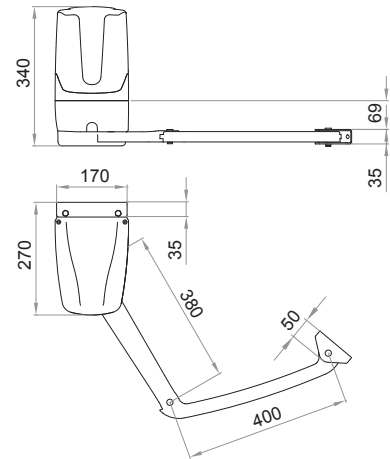

KIT

1

COD. 628010
Art. GEKO/2
Electromechanical automation for swing gates

KIT

1

COD. 678251
Art. NET24N
Universal digital control board for 1 or 2 operators, 24V, with or without magnetic encoder

KIT

2

COD. 629260
Art. GEKO/BA
Aluminium articulated arm

KIT

3

COD. 662080
Art. LINEAR/XS
Pair of mini synchronizable photocell for outdoor installation. Maximum range 20m

4

COD. 664000
Art. PILLY/60
55cm column for photocell (2 pcs)

5

COD. 663090
Art. GT-KEY
Metal vandal proof keyswitch with two contacts, surface mounted. Supplied with 2 keys.

KIT

6

COD. 661083
Art. AURA24
24V flashing light, LED, with integrated antenna, 433 MHz

KIT

COD. 672645
Art. GTI4
Serialized white 4-channel remote control, 433 MHz, with 3 coding: HCS Rolling-Code, Dip-Switch and new D.A.R.T. coding

COD. 668010
Art. 127
Warning sign

KIT for further details on the kits see price list 2019

SPECIFIC ACCESSORIES

COD. 629260
Art. GEKO/BA
Aluminium articulated arm

COD. 629263
Art. GEKO/BLA
Long arm for GEKO, aluminium

COD. 629262
Art. GEKO/BL
Long arm for GEKO, painted galvanized steel

COD. 629261
Art. GEKO/BS
Roll sliding arm, painted galvanized steel

COD. 629350
Art. KIT CLIMB
Adapter set for doors on slopes (for doors up to 2m - 150 kg; max gradient 12%)

COD. 629280
Art. GEKO/SF
External unlocking device by cable (4,5m). To be used with BLINDOS

COD. 665000
Art. BLINDOS
Aluminium safety enclosure, with European cylinder, ready for unlocking device by cable.

COD. 629250
Art. COL 515
Anti-fall Stainless steel cable with 2 holes for swing gates